



Model Number:	SD3-444T-6-RR-E-100
MFG PN:	19865
List Price:	

All data shown at HIGH voltage setting

Format: STD 3 Phase

Electrical Data				General Data			
Rated Motor Output Power	100.0	HP		Frame Size	444T		
Rated Motor Speed	1190	r/min 60Hz		Enclosure	TEFC		
	985	r/min 50Hz		Mounting	Rigid		
Rated Motor Voltage (3 Phase)	460	V/60Hz		NEMA Design	B		
	380	V/50Hz		IP Rating	55		
Rated Motor Current	119	A (In) @ 60Hz		Insulation Class	F		
	142	A (In) @ 50Hz		Tropicalization	1		
FL Current @ 208V	None	A (In) @ 60Hz		Duty	Cont.		
Service Factor	1.15	@ 60Hz		Cable Entry	None		
	1.15	@ 50Hz		Feet Removable	0		
KVA Code	G	60Hz		Double Drilled	0		
	F	50Hz		Frame Material	Cast		
Nominal Efficiency	95.0	% @ 60Hz		Shaft Material	None		
	94.5	% @ 50Hz		Coating	RAL	7024	
Nominal Power Factor	0.83	cosθ @ 60Hz					
Full Load Torque Ft-Lb	S			Mechanical Data			
Load Data	Trq Ft-Lb	Trq %FL	Current Amps	Bearing DE Side	NU319		
Locked Rotor				Bearing NDE Side	6319		
Breakdown	520.1133389	210.0	-	Comp Ring (wavy washer)	DE		
Pull Up	333.7535106	197.0	-	Weight	600.8625	Lbs	
Load Data	RPM	Eff %	Current Amps	Moment of Inertia	None	kg.m3	
125% of FL	1774.4	93.41	82.79	Site Conditions			
75% of FL	1785.5	94.29	52.63	Temp Rise @ Full Load °C	None	@ 60Hz	
50% of FL	1790.5	93.78	40.19	Ambient Temperature °C	40		
No Load	1199.0	0	26.53	Altitude Above Sea Level (M)	1000		
Brake Torque (N-M)	100.0	Loaded Torque Curves		None			
Brake Coil Voltage	None	P1 = Output Power (KW), S = Slip (% of Sync RPM), η = Efficiency (%), cosφ = Power Factor					

CT VFD Range	
Haz Loc Rating	
Options:	
UL File Number	
CSA File Number	
DOE File Number	
CE APPROVAL	
Wiring Diagram	NEMA-3-6-D

Techtop Industries -2815 Colonnades Court - Peachtree Corners, GA 30071 - Phone: (678) 436-5540



Model Number: SD3-444T-6-RR-E-100
MFG PN:
List Price: 19865

Dimensional Drawing (For Reference Only)

841-444T100U6B

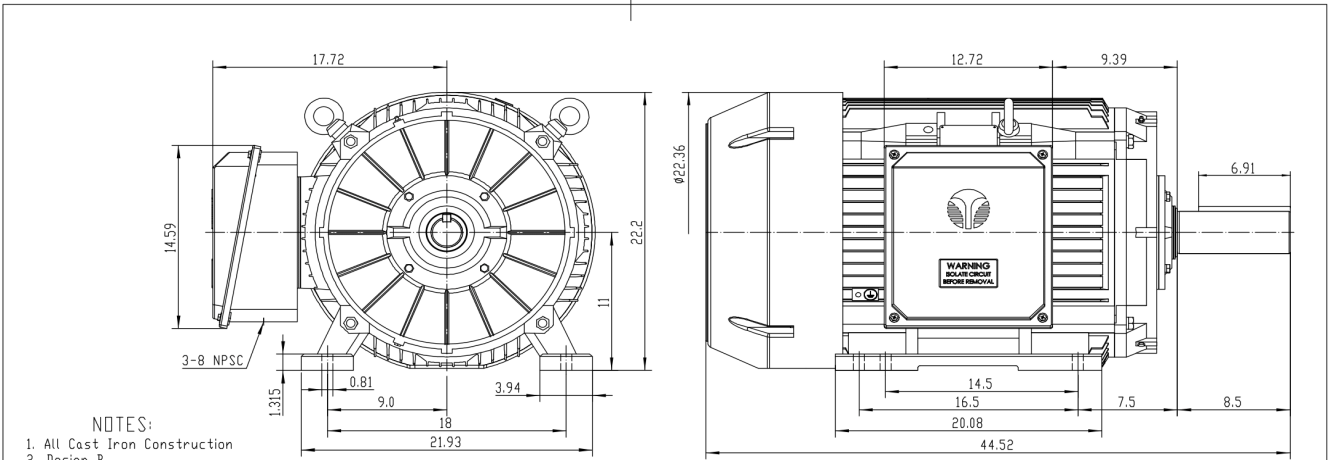

- NOTES:**
- All Cast Iron Construction
 - Design B
 - IP55 Labyrinth seals on DE and ODE
 - H Class Insulation System
 - Max Winding Temperature rise 80°C
 - Max bearing temperature rise 45°C for 4 pole and 50°C for 2 pole motors when direct coupled.
 - Regreasable bearings
 - External Grounding provisions
 - Maximum foot flatness deviation .127 mm
 - Conductive Polymer Cooling Fan
 - Diagonally Split Conduit Box rotatable in 90° Increments
 - Lead seals in conduit box
 - Maximum no load sound power 85 dBA(2 pole), Maximum no load sound power 70 dBA(4 pole), Maximum no load sound power 64 dBA(6 pole).
 - No Load Motor Vibration not to exceed
 - Radial 60HZ - 2.03mm/s (2,4 pole) and 1.52mm/s (6 pole)
 - Axial 60HZ - 1.52mm/s
 - 300 series Stainless Steel hardware
 - Epoxy Coating meeting ASTM B117-97 for 96 h
 - All internal surfaces coated with anti-corrosion coating.
 - Internal Shaft Grounding brush installed on drive end.
 - No Load test report included with motor

TECHTOP IEEE 841 SEVERE DUTY ELECTRIC MOTOR																																																	
MODEL: SD3-444T-6-RR-E-100	TECHTOP.COM																																																
<table border="1"> <tr> <th>NEMA</th> <th>60 Hz</th> <th>50 Hz</th> <th>MFG PN</th> <th>T 444T100UBB</th> </tr> <tr> <td>HP</td> <td>100</td> <td>100</td> <td>SER #</td> <td>160310249</td> </tr> <tr> <td>RPM</td> <td>1190</td> <td>985</td> <td>DATE</td> <td>09/09/02</td> </tr> <tr> <td>VOLT(Ø)</td> <td>460</td> <td>380</td> <td>DESIGN</td> <td>B</td> </tr> <tr> <td>FLA</td> <td>119</td> <td>142</td> <td>FRAME</td> <td>444T</td> </tr> <tr> <td>SF</td> <td>1.15</td> <td>1</td> <td>ENCL</td> <td>TEFC</td> </tr> <tr> <td>KVA CODE</td> <td>G</td> <td>F</td> <td>IP</td> <td>55</td> </tr> <tr> <td>NOM EFF</td> <td>0.950</td> <td></td> <td>DUTY</td> <td>Cont</td> </tr> </table>	NEMA	60 Hz	50 Hz	MFG PN	T 444T100UBB	HP	100	100	SER #	160310249	RPM	1190	985	DATE	09/09/02	VOLT(Ø)	460	380	DESIGN	B	FLA	119	142	FRAME	444T	SF	1.15	1	ENCL	TEFC	KVA CODE	G	F	IP	55	NOM EFF	0.950		DUTY	Cont	<table border="1"> <tr> <td>INS CL</td> <td>H</td> </tr> <tr> <td>AMB</td> <td>40</td> </tr> <tr> <td>WEIGHT</td> <td>1643.3 lbs</td> </tr> <tr> <td colspan="2">MADE IN CHINA</td> </tr> </table>	INS CL	H	AMB	40	WEIGHT	1643.3 lbs	MADE IN CHINA	
NEMA	60 Hz	50 Hz	MFG PN	T 444T100UBB																																													
HP	100	100	SER #	160310249																																													
RPM	1190	985	DATE	09/09/02																																													
VOLT(Ø)	460	380	DESIGN	B																																													
FLA	119	142	FRAME	444T																																													
SF	1.15	1	ENCL	TEFC																																													
KVA CODE	G	F	IP	55																																													
NOM EFF	0.950		DUTY	Cont																																													
INS CL	H																																																
AMB	40																																																
WEIGHT	1643.3 lbs																																																
MADE IN CHINA																																																	

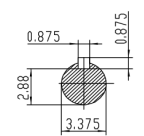
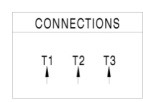

 ShangHai HIMAK Electrical Machinery CO., LTD		NEMA TEFC 444T-100HP-6P	
		IEEE-841 UNITS:INCH	
Design	Standard	NO:	CY260.A20.010
Checker	Allow	STEP MARK	1:6.5 SORT Cast iron Motor
Auditing	Date		

Components			
Item	Model	Description	List Price
C-Face Kit			
D-Flange Kit			
DE Endplate Kit			
NDE Endplate Kit			
Junction Box			
Cooling Fan Cover			
Cooling Fan			
Replacement Feet			
DE Bearing Retainer Kit			
NDE Bearing Retainer Kit			

